

EMBOSSED TAPE PACKING

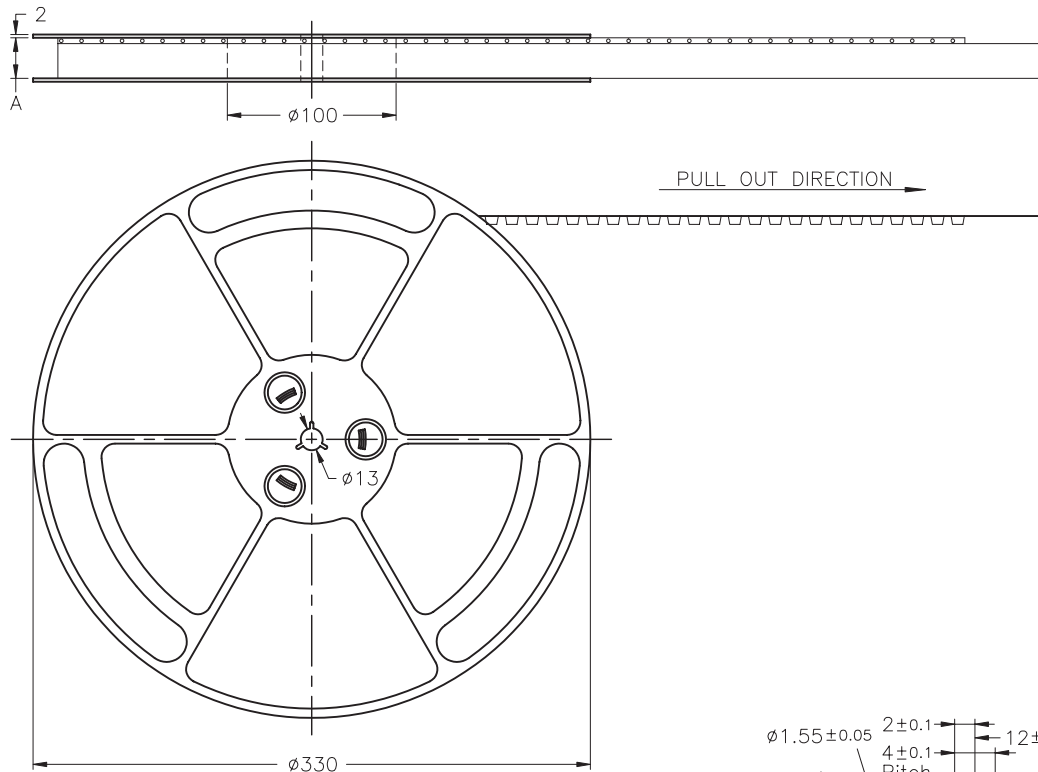

Note:

1. 10 sprocket hole pitch cumulative tolerance ± 0.2 .
2. Carrier camber is within 1 mm in 100mm.
3. Material : Black Conductive Polystyrene Alloy
100% recyclable.
4. All dimensions meet EIA-481-3 requirements.
5. Thickness : 0.3 ± 0.05 mm.
6. Component load per 13" reel : 3000 pcs.
7. For tape width (dimension A) 16mm and 24mm a pilot hole is provided on one side. For tape width (dimension A) 32mm and 44mm pilot holes are provided on both sides.

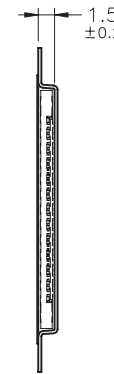
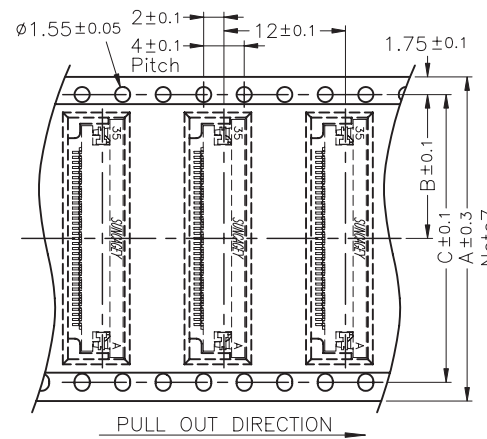
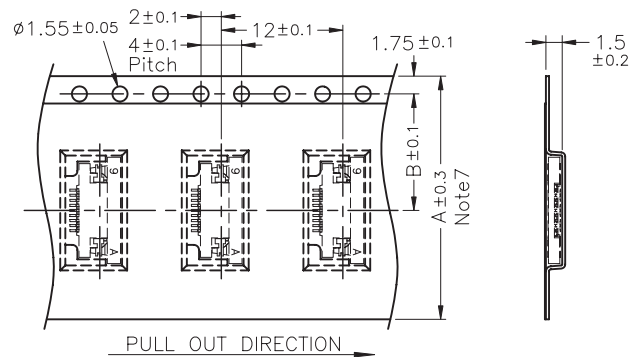

Note7

No. of Contacts	DIM. A	DIM. B	DIM. C
4	16	7.5	—
↓			
6			
↓			
7	24	11.5	—
↓			
22			
↓			
23	32	14.2	28.4
↓			
33			
↓			
34	44	20.2	40.4
↓			
50			

MORETHANALL
CONNECTORS
ASSEMBLIES

PART NO. & { •R c , fiPU å [Rfifi

DWG NO. & { •R c , fiPU å [Rfifi

FILE NO.

UNIT / mm

SCALE 1 : 1

CHECKED BY CY

DRAWING BY

PROJECTION

TOLERANCES ARE

.X ± 0.2
.XX ± 0.1
.XXX ±
AWG

DESCRIPTION:

AREA

REVISIONS

HK

DATE

煜倫股份有限公司

